

### Lockable Loft Access Door Operating Instructions

CODE GL251-03

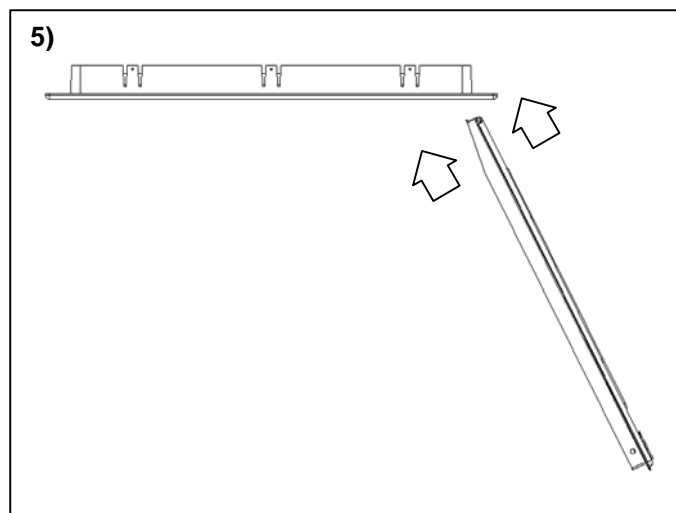
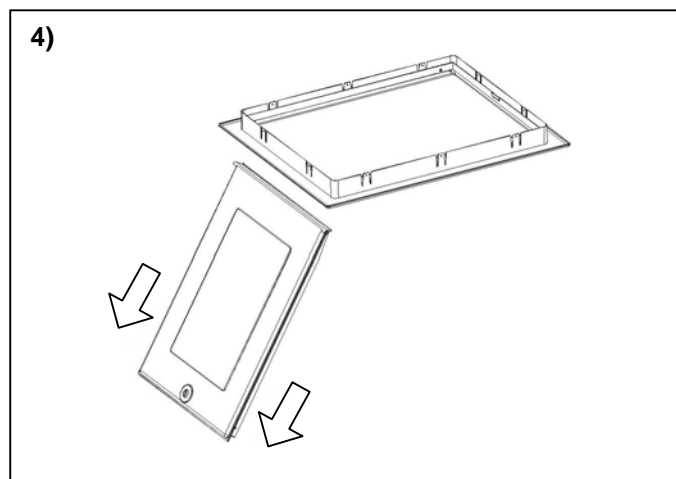
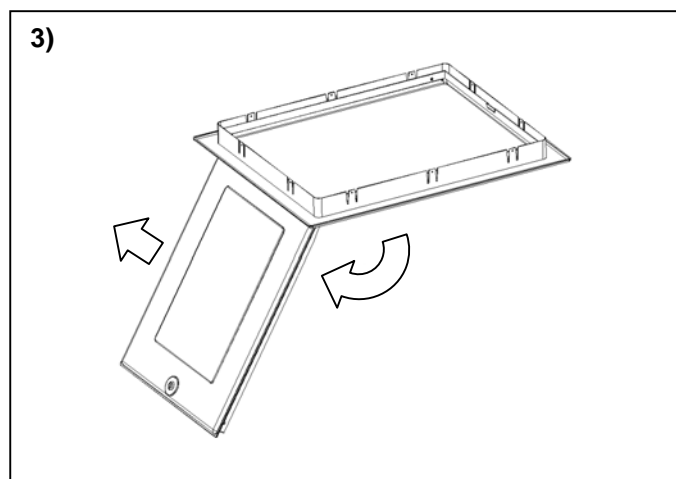
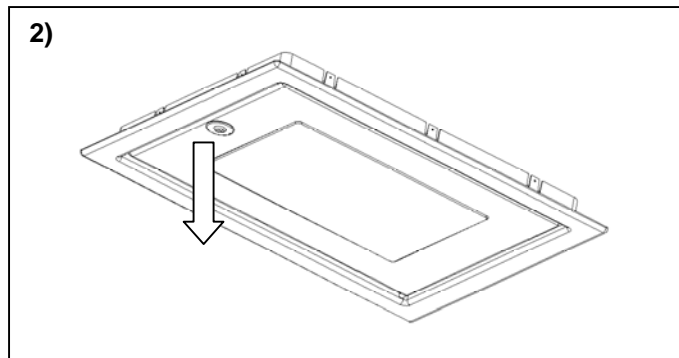
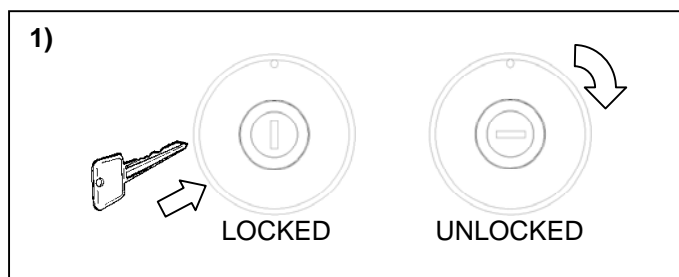

#### Operating Instructions:

- 1) To unlock the door insert the key into the lock and turn the key 90° clockwise. Be sure to support the door while unlocking.
- 2) Once the door is unlocked it will swing open from the frame.
- 3) To remove the door for easier access, open the door beyond the vertical and then slide sideways slightly to disengage one hinge and then the other.
- 4) Carefully pull the door away from the frame.
- 5) To replace the door, offer up to the frame at the angle shown. Locate one of the hinge lugs into place in the frame. Still holding at the same angle, locate the second lug. Centralise the door in the frame and close.
- 6) Lock the door by inserting the key into the lock and turn the key 90° anticlockwise.

Access to your loft may be made easier using the Manthorpe Loft Ladder (Code GL256).

**THIS IS NOT A STRUCTURAL PRODUCT AND MUST NOT BE WALKED OR STEPPED ON**

MANTHORPE BUILDING PRODUCTS LTD  
MANTHORPE HOUSE  
BRITAIN DRIVE  
CODNOR GATE BUSINESS PARK  
RIPLEY  
DERBYSHIRE DE5 3ND

TEL: 01773 514 200  
FAX: 01773 514 262  
EMAIL:  
[sales@manthorpe.co.uk](mailto:sales@manthorpe.co.uk)  
WEB:  
[www.manthorpe.co.uk](http://www.manthorpe.co.uk)

DRN R.P

Date 8.04.04

The company maintains a policy of continuous development of its product range and reserves the right to amend the specification without notice.

DRG No

**MBP 8215**

Issue

**A**